

Combustible Floor Installation

Floor Heat Shield Pedestal Support: Owner/Contractor is responsible for engineering the floor to support the Floor Heat Shield Pedestal and weight of Tulikivi Unit as specified without deflection.

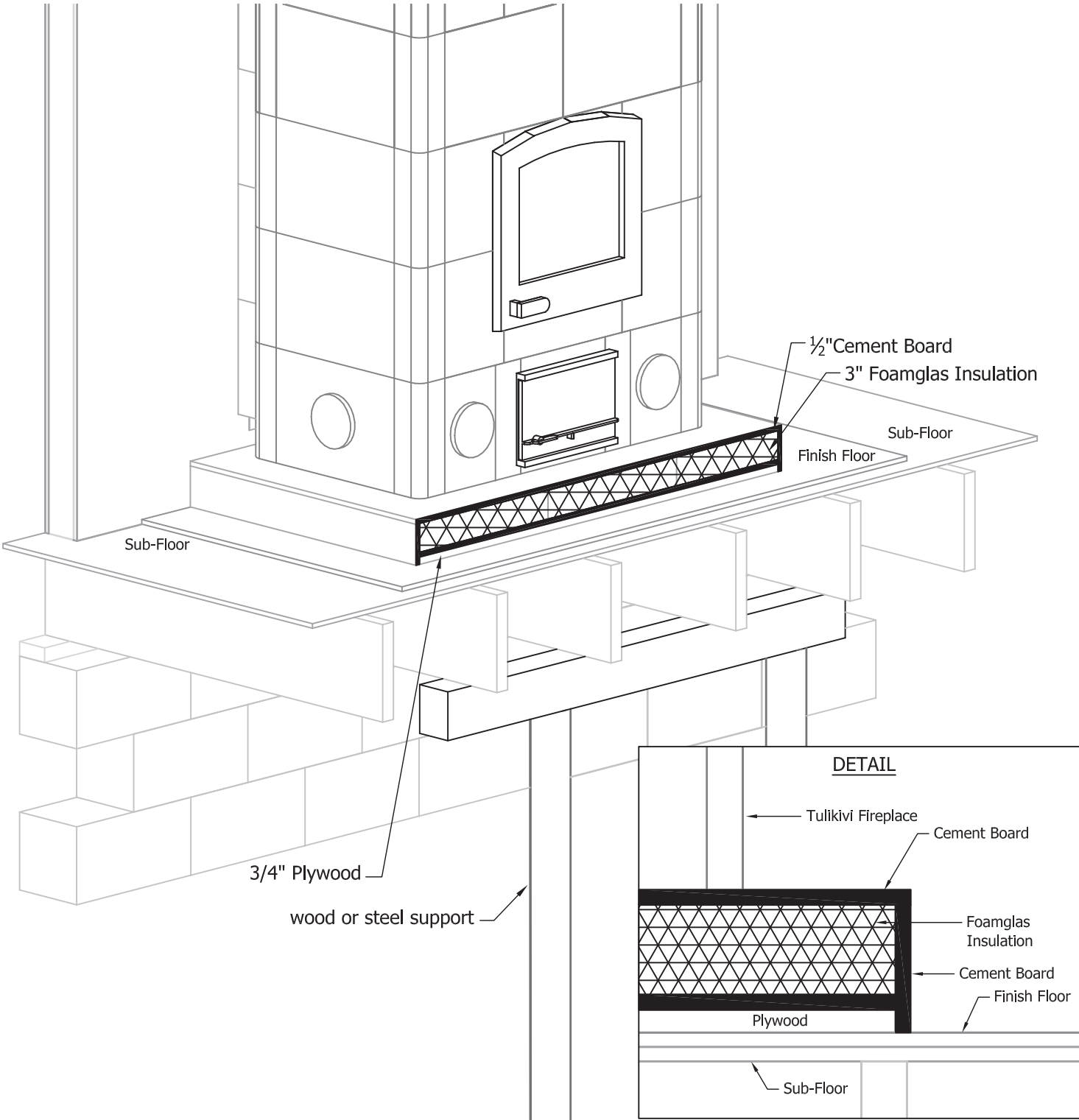

Tulikivi provides these drawings as a conceptual aid for the North American market. They illustrate some common conditions installers have encountered and general methods which might be considered for addressing such conditions. Please note that this material is not tailored to any particular condition; It is not intended to be a substitute for or supplant the technical manual TTM-1; and it is not a warranty with respect to the merchantability, suitability, or fitness for a particular purpose regarding Tulikivi products or methods illustrated. It is not designed to replace good engineering practices, local building codes or the formal and practical training and advice of a qualified builder. The material only suggests ways architects, engineers, builders, installers and owners can enhance their projects by including a Tulikivi fireplace, bakeoven and cookstove.