

FLOOR SUPPORT:
 Owner/Contractor is responsible for engineering support slab or floor under the hearths to support the weight of the Tulikivi Fireplace as specified WITHOUT DEFLECTION.

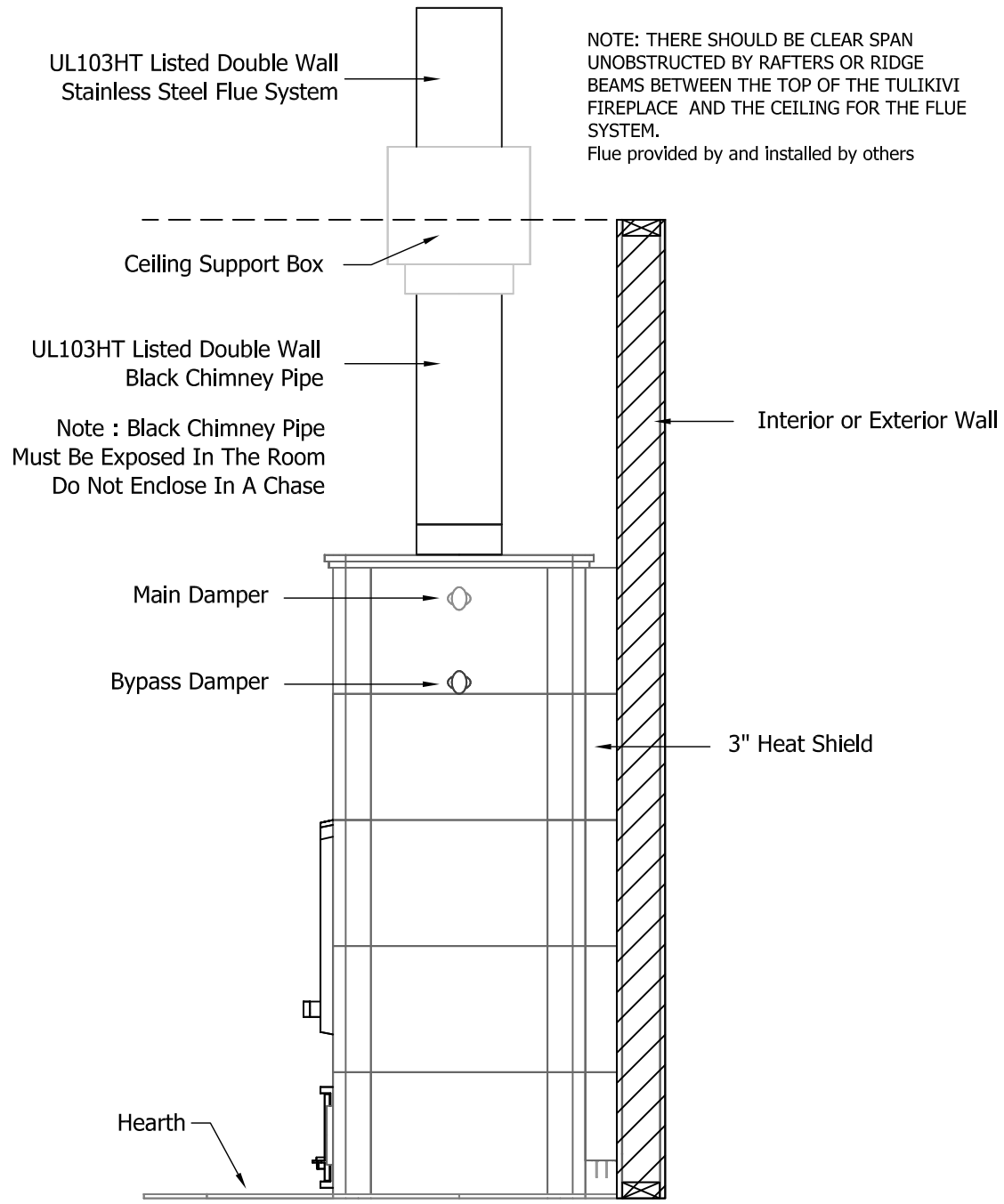

MID-ATLANTIC MASONRY HEAT
 PO Box 58
 Madison, VA 22727
 (434) 979-9709

**BASE VENT OPTION
 EXISTING FIREPLACE**



NOTE: THERE SHOULD BE CLEAR SPAN UNOBSTRUCTED BY RAFTERS OR RIDGE BEAMS BETWEEN THE TOP OF THE TULIKIVI FIREPLACE AND THE CEILING FOR THE FLUE SYSTEM.
Flue provided by and installed by others

UL103HT Listed Double Wall Stainless Steel Flue System

Ceiling Support Box

UL103HT Listed Double Wall Black Chimney Pipe

Note : Black Chimney Pipe Must Be Exposed In The Room Do Not Enclose In A Chase

Interior or Exterior Wall

Main Damper

Bypass Damper

3" Heat Shield

Hearth

3 inches

FLOOR SUPPORT:
Owner/Contractor is responsible for engineering support slab or floor under the hearths to support the weight of the Tulikivi Fireplace as specified WITHOUT DEFLECTION.

NOTE: THERE SHOULD BE CLEAR SPAN UNOBSTRUCTED BY RAFTERS OR RIDGE BEAMS BETWEEN THE TOP OF THE TULIKIVI FIREPLACE AND THE CEILING FOR THE FLUE SYSTEM.
Flue provided by and installed by others

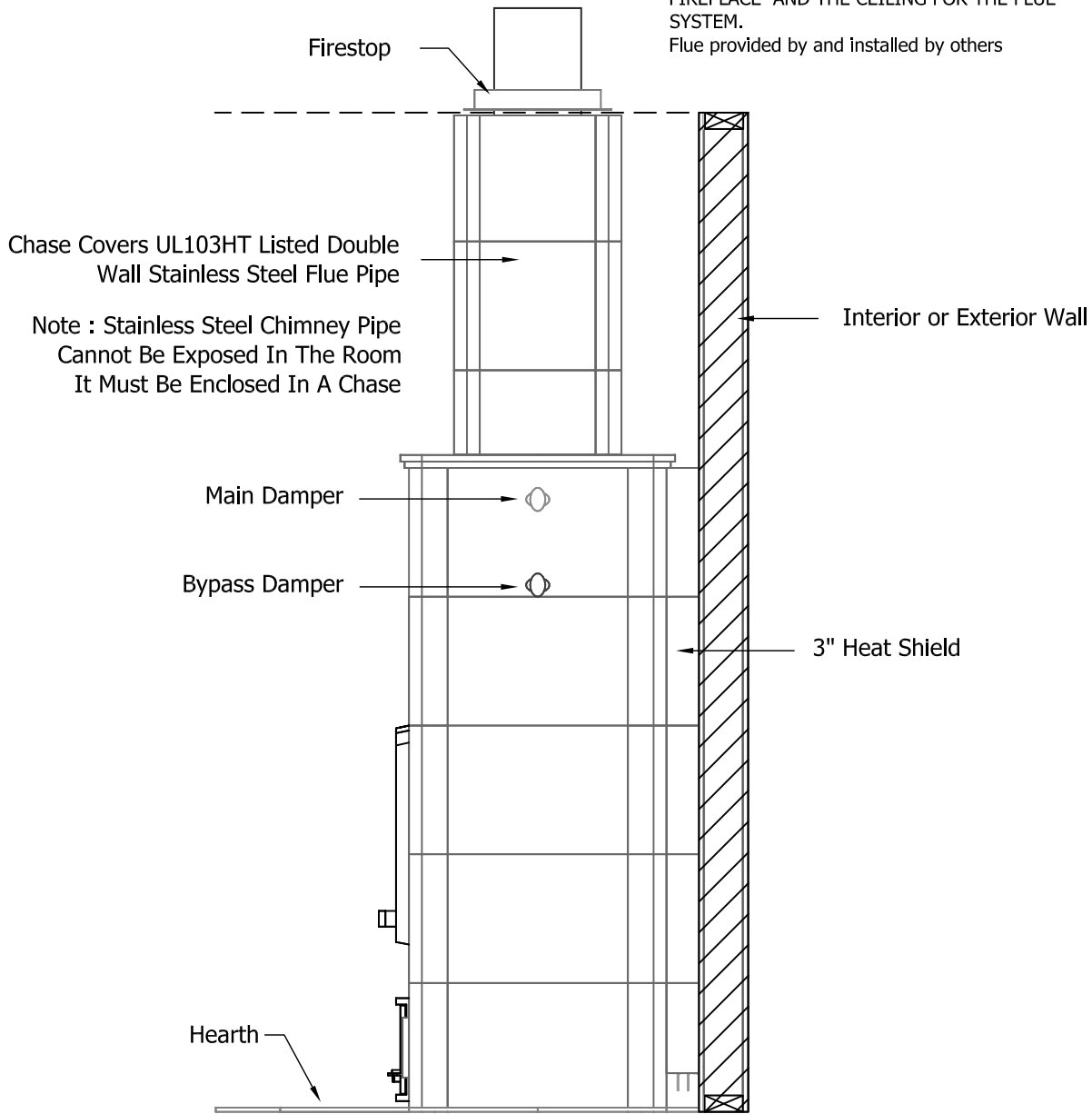

FLOOR SUPPORT:
Owner/Contractor is responsible for engineering support slab or floor under the hearths to support the weight of the Tulikivi Fireplace as specified WITHOUT DEFLECTION.

3 inches

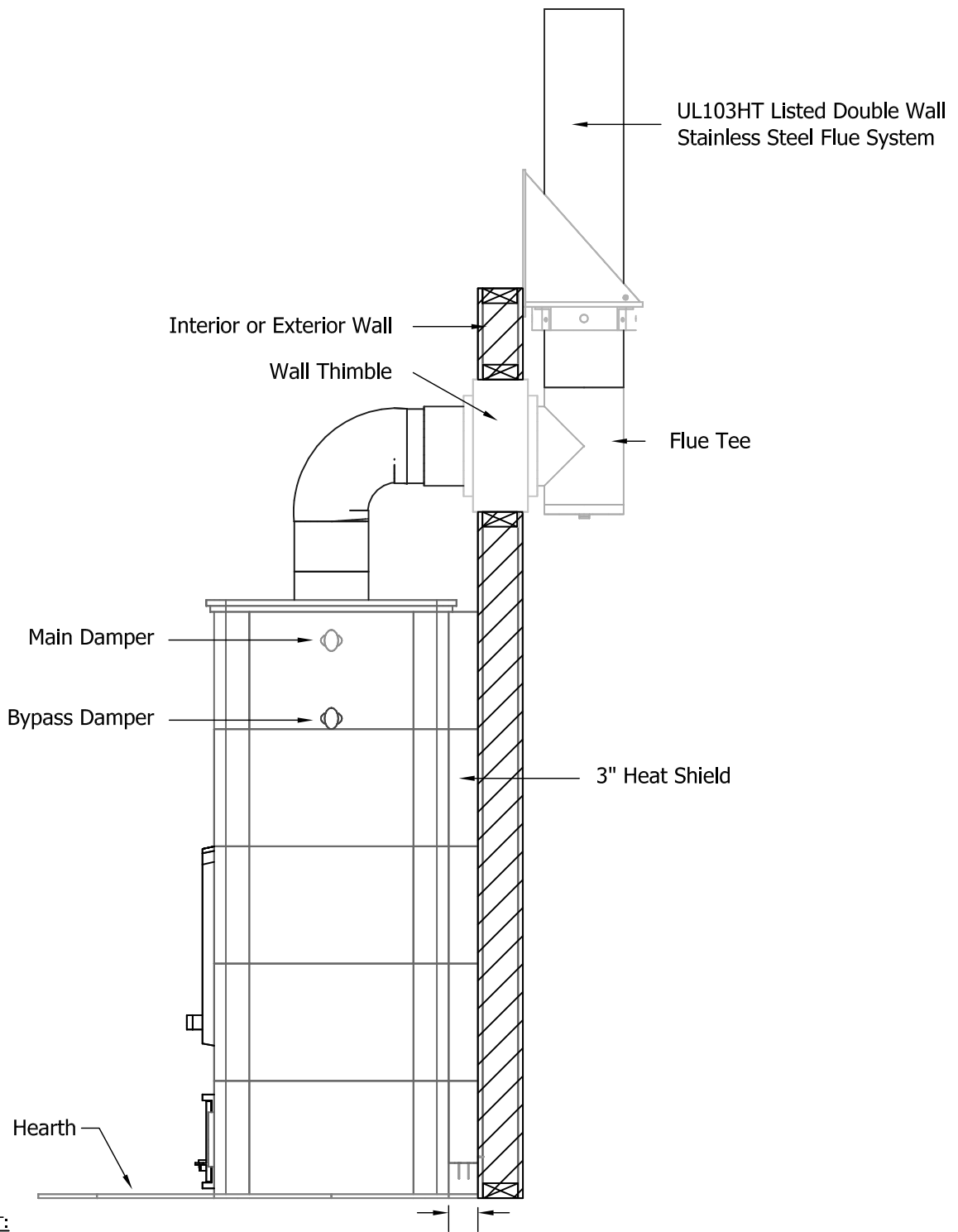

FLOOR SUPPORT:
 Owner/Contractor is responsible for engineering support slab or floor under the hearths to support the weight of the Tulikivi Fireplace as specified WITHOUT DEFLECTION.